

Deck Jet Installation Instructions

IMPORTANT SAFETY INSTRUCTIONS *READ & FOLLOW ALL INSTRUCTIONS* SAVE THESE INSTRUCTIONS

⚠ CAUTION

Before installing this product, read and follow all warning notices and instructions accompanying this product. If you have application questions or would like additional copies of these instructions, please call (800) 831-7133.

Important Notice



Attention Installer.

This manual contains important information about the installation, operation and safe use of this product. This information should be given to the owner/operator of this equipment.

Thank you for your purchase of the Pentair Deck Jet. This innovative water effect is designed to be cast into the concrete deck or gunite sidewall of a swimming pool. It can also be mounted through the sidewall of a vinyl liner in-ground or above ground pool. It is furnished with five water effect eyeballs, one of which you will install in the body after the pool is complete.

It is recommended that you supply the Deck Jet with filtered water. Also, if more than one Deck Jet is used on this pool, we recommend that a PVC ball valve be used to control the flow to EACH effect. This is because the flow and pressure requirements are so low that any difference in water pressure caused by piping length will be noticed.

The supply piping to the Deck Jet can be any size (1/2" recommended). The connection on the bottom of the body is 1 1/2" slip.

If the Pentair Deck Jet is to be mounted into concrete or gunite:

1. Place the plastic parts bag in a safe location. This contains all the parts you will need to activate the water effects after the pool hardscape is complete.
2. Leave the red gunite shield pressed securely in the body to prevent contamination of the internal threads.
3. You will need to adapt your supply piping to the 1 1/2" PVC slip connection with a reducing bushing. Glue the bushing to the body.
4. Glue the supply piping to the bushing.
5. Secure the body to prevent movement during the gunite/concrete placement. You can drill holes in the horizontal flange and wire the body to the rebar. Because the Deck Jet is round, you can orient it in any direction.
6. The top flange of the shield plug should be flush with the FINAL prepared surface.

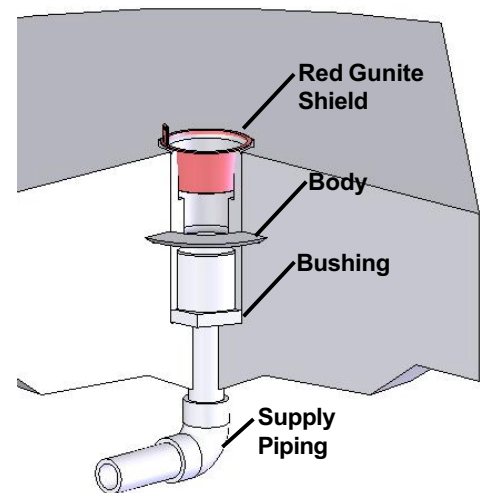

(continued on the back side)

If the Pentair Deck Jet is to be mounted into the sidewall of a vinyl lined pool:

1. Place the plastic parts bag in a safe location. This contains all the parts you will need to activate the water effects after the pool hardscape is complete.
2. Cut a 2-3/8" diameter hole, above water level, at the location desired.
3. Put a gasket on the body and insert the body through the hole from the outside.
4. Put on the remaining gasket, friction ring, and nut. Tighten the nut until the gasket is compressed slightly. All threads on the nut should be engaged, but it is recommended that the body not stick out of the nut too far. If desired, a bead of silicone caulking can be applied to better seal the pool wall.
5. You will need to adapt your supply piping to the 1½" PVC slip connection with a reducing bushing (1/2" piping is recommended).
6. Glue the supply piping to the bushing.
7. Support the piping on the outside of pool to prevent potential pipe breakage.

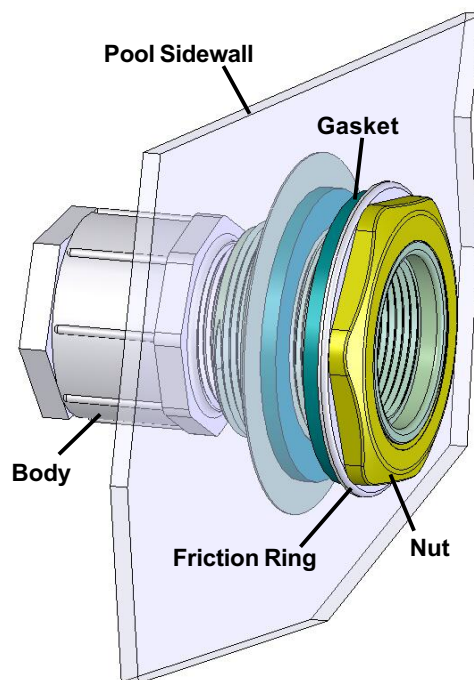

Replacement Parts

Item No.	P/N	Description
1	87200800	Fitting Nut ,Sealing Liner 2"
2	87200700	Friction Ring, SIF
3	87201200	Gasket TH-AGF 3.5" OD x 2-3/8" ID
4	590005	Plug, Gunite Shield, L20
5	590010	Eyeball Kit
	includes:	Installation Card
6	590011	Accessory Kit
	includes:	Capture Ring – (2 qty.) O-ring – (3 qty.) Filter Pad – (2 qty.) Silicone Lubricant – (1 qty.)

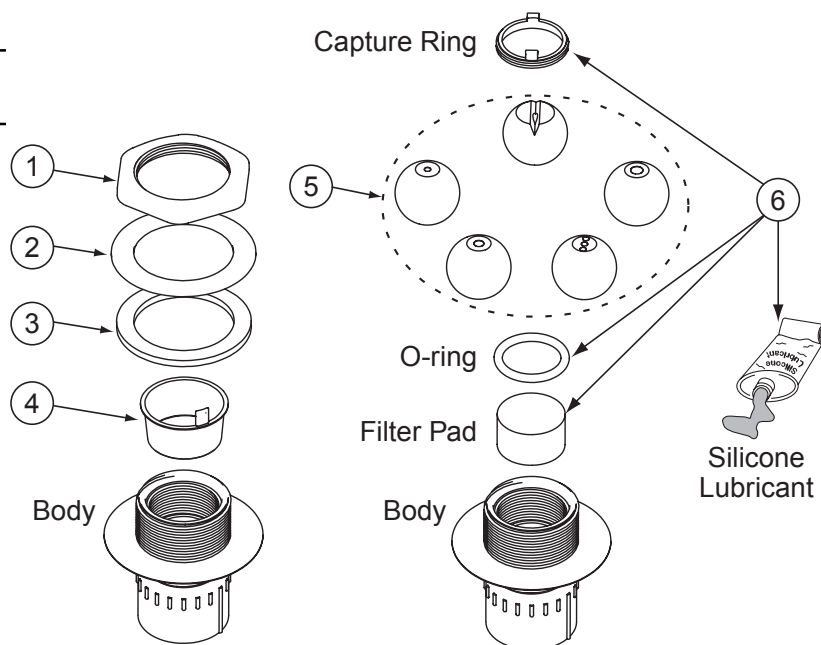

SAVE THESE INSTRUCTIONS.



Rainbow Pool Products

PO Box 2388, Mansfield Qld 4122

Telephone STD 61-7-3849 5385

Facsimile STD 61-7-3849 5384

Email: info@rainbowpoolproducts.com.au

Web: www.rainbowpoolproducts.com.au